



SPECTATOR GUIDE

BMW
IBU WORLD CUP
BIATHLON
CANMORE, ALBERTA
FEBRUARY 1-7, 2016

canmorebiathlon.ca

COME CHEER ON YOUR
CANADIAN ATHLETES
AS THEY COMPETE WITH
WORLD CUP SUPERSTARS
ON HOME SNOW!

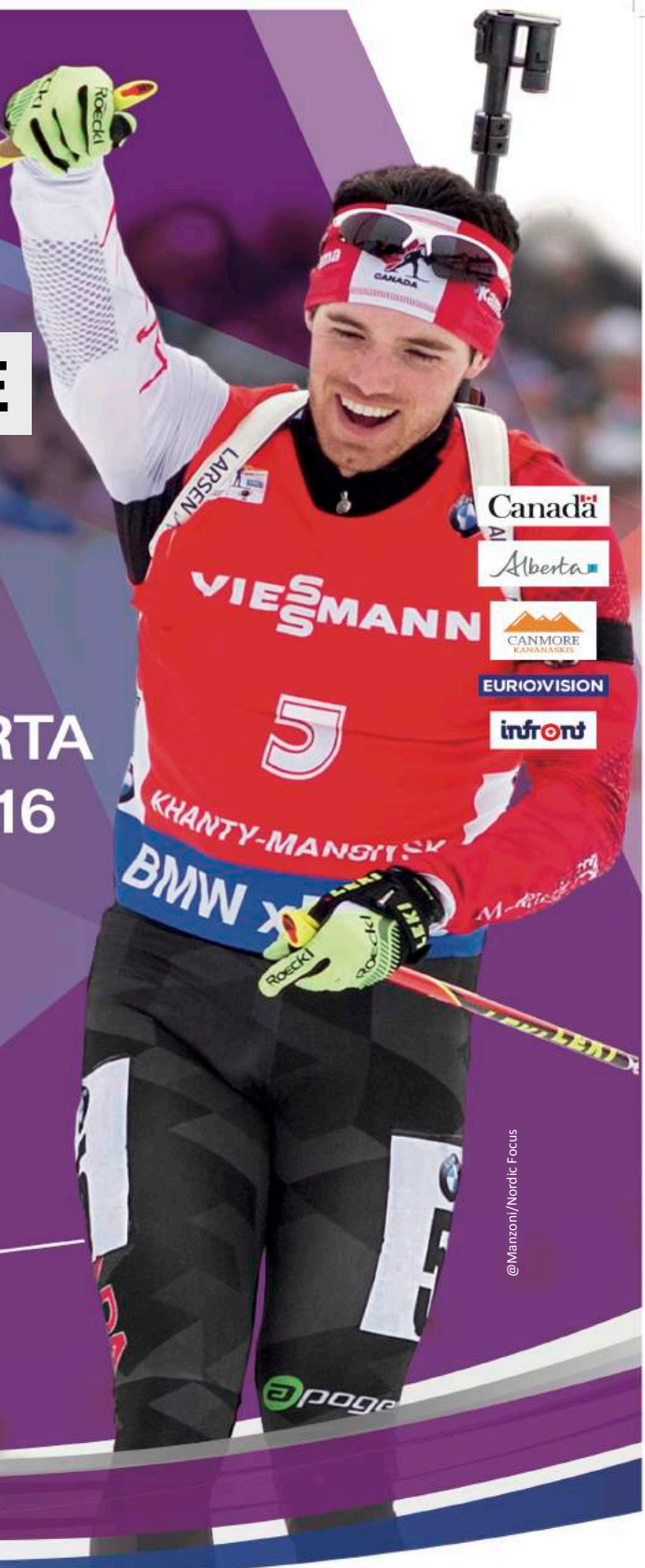

@Manzoni/Nordic Focus



BMW IBU World Cup Biathlon 7



Competition Schedule:

| | |
|-----------------------|--|
| Thursday February 4 : | 11:15 a.m. – SPRINT Men 10km |
| Friday February 5 : | 11:15 a.m. – SPRINT Women 7.5km |
| Saturday February 6 : | 10:00 a.m. – MASS START Men 15km 11:30 a.m. – MASS START Women 12.5km |
| Sunday February 7 : | 10:10 a.m. – Single Mixed Relay 2:05 p.m. – Mixed Relay |

This World Cup event is held at the Canmore Nordic Centre. All recreational trails that are not being used for the competitions are opened to the public. **Kids ski for free on race days!**

FREE ADMISSION TO THE CANMORE FAN ZONE! There's always space at every race for all of Canmore's loudest and most enthusiastic fans!

Ceremonies and Special Events

Opening Ceremonies

Wednesday February 3rd at 5:30 p.m.

Live Music, Parade of Nations, & Fireworks!

Location: Downtown Canmore Pond, corner of 7th Ave & 10th St

Downtown Awards Ceremonies

Saturday February 6th at 5:30 p.m.

Location: Canmore Civic Centre Plaza

Canmore Winter Carnival – 6 Weeks of Winter Fun activities!

February 1 – March 13, 2016

www.canmorewintercarnival.com

#CanmoreLivesWinter



THANK YOU TO OUR VALUED LOCAL SPONSORS!

Canada 

Alberta 



BMW IBU World Cup Biathlon 7

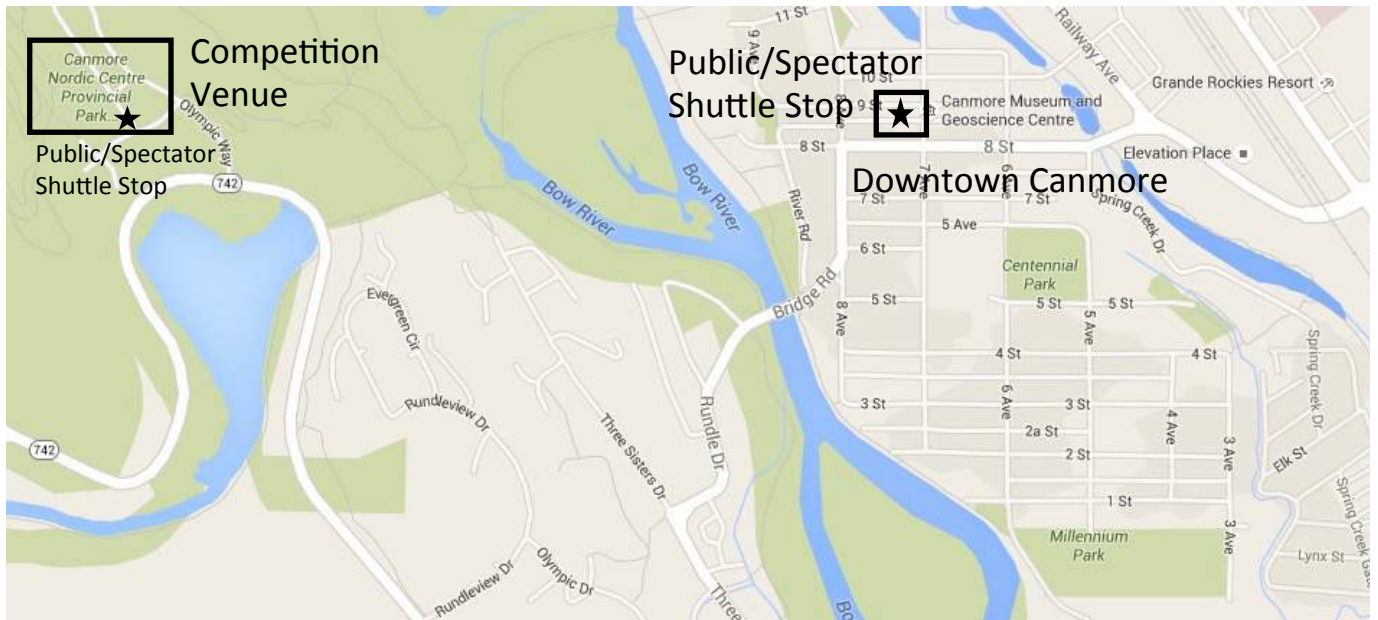

SHUTTLE INFORMATION

February 1-3, 2016

Bus every 30 minutes starting at 07:45
Last bus to leave Canmore Nordic Centre at 14:00

| Departs 9 th St bus stop | Departs Nordic Centre |
|-------------------------------------|-----------------------|
| 07:45 | 08:00 |
| 08:15 | 08:30 |
| 08:45 | 09:00 |
| 09:15 | 09:30 |
| 09:45 | 10:00 |
| ↓ | ↓ |
| 13:45 | 14:00 |

February 4-7, 2016 (Race Days!)

Bus every 15 minutes starting at 07:45
Last bus to leave Canmore Nordic Centre at 15:15

| Departs 9 th St bus stop | Departs Nordic Centre |
|-------------------------------------|-----------------------|
| 07:45 | 08:00 |
| 08:00 | 08:15 |
| 08:15 | 08:30 |
| 08:30 | 08:45 |
| 08:45 | 09:00 |
| ↓ | ↓ |
| 15:00 | 15:15 |

GENERAL INFORMATION

Parking at Canmore Nordic Centre

NO PUBLIC PARKING Feb 4 - 7, 7 a.m.- 3 p.m.
LIMITED Public Parking Jan 28 - Feb 3, 7 a.m.-3 p.m.
Lots 1 & 2 closest to Biathlon Range closed all days.

Free Public Shuttle Buses February 1 – 7

Departing from the downtown Roam bus stop on 9th Street (behind Downtown Visitor Information Centre)
Free Public Parking Lot available at this location.

Community Art Walks to the Nordic Centre

Artist-led walks from the Canmore Civic Centre to the Canmore Nordic Centre. Departing from the Civic Centre 1 hour 15 minutes before each race Feb 4 – 7

World Cup Information Desk/Ticket Pickup

Feb 1-7, 9 a.m. – 1 p.m.
Located just inside the lobby of the Canmore Nordic Centre Day Lodge.

To pick up Grandstand/VIP tickets, please bring your receipt and ID.

*Please note: this Info Desk is separate from the Canmore Nordic Centre Information/Ticket office

CANMORE NORDIC CENTRE BIATHLON SPECTATORS MAP

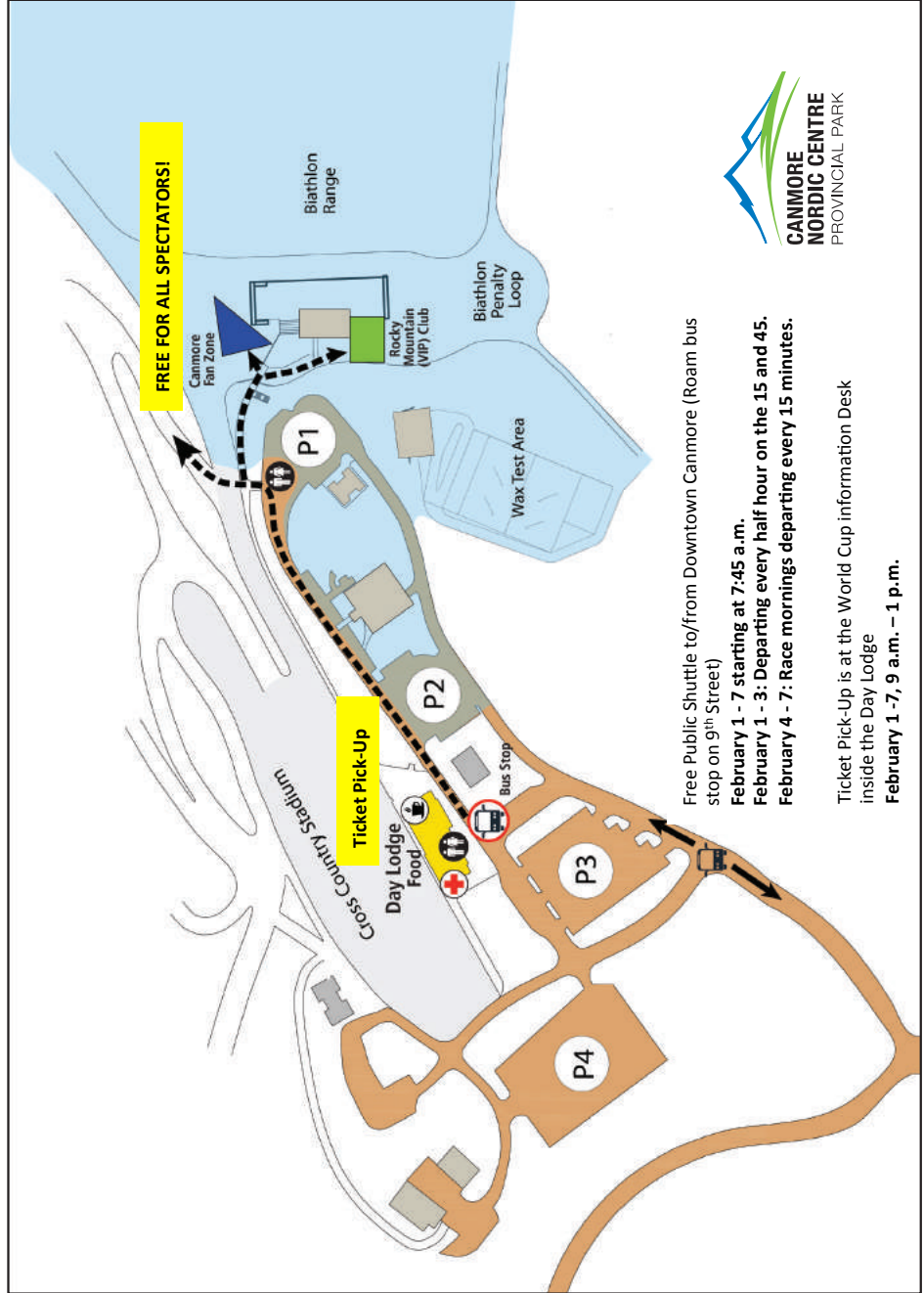

FREE FOR ALL SPECTATORS!

Ticket Pick-Up

Free Public Shuttle to/from Downtown Canmore (Roam bus stop on 9th Street)
February 1 - 7 starting at 7:45 a.m.
February 1 - 3: Departing every half hour on the 15 and 45.
February 4 - 7: Race mornings departing every 15 minutes.

Ticket Pick-Up is at the World Cup information Desk inside the Day Lodge
February 1-7, 9 a.m. - 1 p.m.



Canmore Nordic Centre Provincial Park

P2 Parking Lots

Parking Lot P1

- TV Compound
- Ambulance

Parking Lot P2

- Temporary Wax Cabins

Parking Lot P3

- Bus drop off/pick up
- Team Vehicles
- Media
- VIP Parking

Parking Lot P4

- VIP Parking

No Public Access

Canmore Fan Zone

Rocky Mountain Club

Food

First Aid

Washrooms

Bus Stop